



**RECORD OF TITLE
UNDER LAND TRANSFER ACT 2017
CROSS LEASE**

**Guaranteed Search Copy issued under Section 60 of the Land
Transfer Act 2017**



R.W. Muir
Registrar-General
of Land

Identifier **WN36B/746**
Land Registration District **Wellington**
Date Issued 10 May 1990

Prior References
WN33B/907

Estate Fee Simple - 1/2 share
Area 600 square metres more or less
Legal Description Lot 9 Deposited Plan 64278
Registered Owners
Valerie Anne Young

| | | | |
|--------------------------|--|-------------------|---|
| Estate | Leasehold | Instrument | L B081010.1 |
| | | Term | 999 years from and including 22.12.1989 |
| Legal Description | Flat 8A Deposited Plan 68971 and Garage 8A Deposited Plan 68971 | | |
| Registered Owners | Valerie Anne Young | | |

Interests

B081010.1 Lease of Flat 8A and Garage 8A DP 68971 Term for the space of 999 years from and including 22.12.1989
Composite CT WN36B/746 issued - 10.5.1990 at 10.46 am (Affects Fee Simple)
Land Covenant in Lease B081010.1 - 10.5.1990 at 10.46 am (Affects Fee Simple)
B081010.2 Lease of Flat 8B and Garage 8B DP 68971 Term for the space of 999 years from and including 22.12.1989
Composite CT WN36B/747 issued - 10.5.1990 at 10.46 am (Affects Fee Simple)
Land Covenant in Lease B081010.2 - 10.5.1990 at 10.46 am (Affects Fee Simple)

| | |
|---|---|
| <p>Approved <i>[Signature]</i> Registered Owner</p> | <p>Pursuant to Section 31A of the Local Government Act 1974, hereby certify that the construction of the buildings containing Flats 8A & 8B and Garages 8A & 8B as shown or described hereon commenced on or after the 1st day of April 1979 and every building permit necessary for the construction thereof as shown or described hereon has been granted by the Kapiti Coast District Council pursuant to its bylaws.</p> <p>Dated this 20th day of February 1990 <i>[Signature]</i> General Manager</p> <p>Areas marked A & B to be subject to restrictive covenants. See leases</p> |
| <p>Total Area Comprised in ... S.T. ... 33B/907 (A1)</p> | <p>1. <i>Ronald William Beadle</i> Registered Surveyor and holder of an annual practicing certificate for the year 1989. I am a registered surveyor pursuant to section 25 of the Survey Act 1976. The survey shown on this plan was made by me or under my direction, and both the survey and the plan are correct and have been made in accordance with the Survey Regulations 1972 or any regulations made in substitution thereof. Dated at <i>OTAKI</i> this <i>15</i> day of <i>FEBRUARY</i> 1990. Signature <i>[Signature]</i></p> <p>Field Book <i>Thomas RB6</i> Reference Plans <i>D.P. 64278</i> Examined <i>[Signature]</i> Correct</p> |
| <p>Approved as to Survey 9.1.3.1990 <i>R.S.</i> Deposited this <i>15</i> day of <i>FEBRUARY</i> 1990. <i>M.S. [Signature]</i> Asst. District Land Registrar</p> | <p>File Received 27.2.90 Instructions 68971</p> |
| <p>MAKURATAWHITI PT 8B1 M.L. 2298</p> <p>MAKURATAWHITI PT 8B3B M.L. 3886</p> <p>MAKURATAWHITI PT 8B1 M.L. 2298</p> | |
| <p>FLATS 8A AND 8B AND GARAGES 8A AND 8B ON LOT 9 D.P. 64278</p> <p>TERRITORIAL AUTHORITY KAPITI COAST DISTRICT Surveyed by <i>R.W. Beadle</i> Scale <i>1:200</i> Date <i>Feb. 1990</i></p> | |
| <p>LAND DISTRICT <i>WELLINGTON</i> SURVEY BLK. & DIST. <i>I.X. WAITOHU</i> NZMS 261 SHT <i>225</i> RECORD MAP No <i>92350</i></p> <p>Printed by Lithpress Wellington, New Zealand. OTAKI 11</p> | |

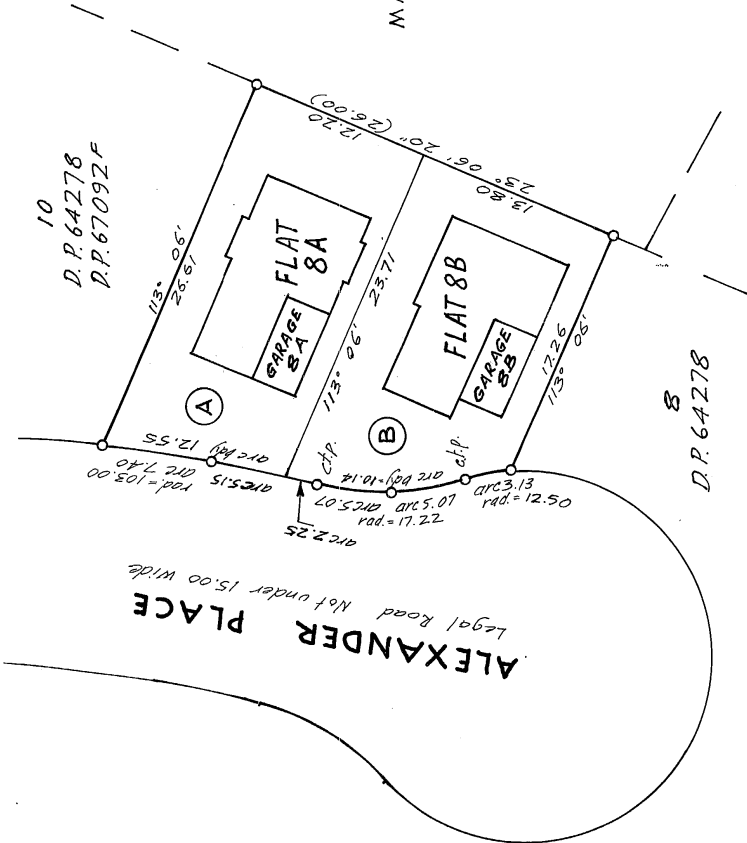

APPROVED

REGISTERED PROPRIETOR

PURSUANT TO A RESOLUTION OF THE OTAKI BOROUGH COUNCIL IN RESOLUTION NO. 1889 P.776 OF THE LOCAL GOVERNMENT ACT 1974 THIS SURVEY PLAN AND CERTIFYING THAT THE PLAN IS IN ACCORDANCE WITH THE PROVISIONS OF THE SURVEY ACT 1980 AND THE SURVEY REGULATIONS 1972 RELATES TO THE AREA TO WHICH THE SURVEY PLAN IS REFERRED AT THE DATE OF APPROVAL OF THE SURVEY PLAN THE COMMON SEAL OF THE OTAKI BOROUGH COUNCIL WAS APPROVED HEREON IN THE PRESENCE OF:

COUNCILLOR

TOWN CLERK

PURSUANT TO SECTION 306(1) OF THE LOCAL GOVERNMENT ACT 1974 I HEREBY CERTIFY THAT ALL THE CONDITIONS SHOWN ON OR REFERRED TO ON THE SURVEY PLAN ARE SATISFACTORY TO THE OTAKI BOROUGH COUNCIL.

DATED AT OTAKI THIS 27th DAY OF August 1988

TOWN CLERK

LEGAL BY A.2.2947 1889 P.776

MILL ROAD

DIAGRAM A
SCALE 1:750

DIAGRAM B
NO SCALE

SEE DIAGRAM A

LOTS 1-4, 8-15 BEING SUBDIVISION OF MAKURATAWHITI PT.10B AND LOT 3 D.P.5327

SEE DIAGRAM B

ALEXANDER ROAD TO WEST

DIAGRAM C
NO SCALE

LAND DISTRICT WELLINGTON

SURVEY BLK. & DIST. IX WAITOHU

NZMS 261 SHT S.25 RECORD MAP No 03/30

Printed by Landsigns Wellington, New Zealand

LAND AUTHORITY OTAKI BOROUGH

Surveyed by TRUEBRIDGE ASSOCIATES

Scale 1:750 Date MARCH 1988

TOTAL AREA 1,080.2 ha

Comprised in C.T. 30816 (ALL)

Z. GEORGE MICHAEL TRUEBRIDGE Registered Surveyor and holder of an authority to survey conferred by the Surveyors Act 1980 hereby certify that this plan has been made from surveys executed by me or under my direction, that both plan and survey are correct and have been made in accordance with the Survey Regulations 1972.

Field Book 5777 P. 21 Franklin Book 4488 243, 254

Reference Plans D.P. 5, 5327, 60678, 60678, 151065, 25014, M.L.'s 1278, 1949, 1986, 2298, 3886

Examined D. Harrison Coroner D. Robinson

Approved as to Survey

Deposited this 10th day of March 1988

Chief Surveyor

Received 27-5-88

64278

L & S FORM 1003